

# Installation instructions

## Selcom RCF1

with device series

door operator

TSG

### Documentation history

No.	Ver.	Date	Processed by
1	1.0	24.04.13	Rau
2	1.1	03.09.15	CSA
3	1.2	26.11.15	JE
4	1.3	03.02.17	CSA
5	1.4	31.12.19	CSA



Fordern Sie die Umbauanleitung **auf Deutsch** an,  
indem Sie den QR Code einscannen.

**Langer & Laumann Ing.-Büro GmbH**  
**Wilmsberger Weg 8**  
**48565 Steinfurt**  
**Germany**

Phone: +49 (2552) 92 7 91 0

E-mail: [info@LuL-Ing.de](mailto:info@LuL-Ing.de)

Web: [www.LuL-Ing.de](http://www.LuL-Ing.de)

© 2019 Langer & Laumann Ingenieurbüro GmbH All rights reserved

All rights for these operating instructions and the product described therein are reserved for **Langer & Laumann Ingenieurbüro GmbH** or their suppliers. In accordance with the laws of copyright protection, these operating instructions may not be copied in whole or in part without written approval of **Langer & Laumann Ingenieurbüro GmbH**, except as part of normal use of the product or to create a back-up copy. However, this exceptional provision does not extend to copies created for third parties or that are sold or transferred to third parties in any other manner. The whole of the material acquired (including all back-up copies) may, however, be transferred to third parties or made available on loan. According to the provisions of the law, preparing a translation also falls under the definition of copying.

**Langer & Laumann Ingenieurbüro GmbH assumes no warranty or guaranty for the content of these operating instructions. It declines any legal guaranty regarding the marketability or suitability for a specific purpose. Langer & Laumann Ingenieurbüro GmbH is not responsible for errors in these operating instructions or for direct or indirect damages associated with delivering, performing or using these operating instructions. Langer & Laumann Ingenieurbüro GmbH reserves the right to revise these operating instructions from time to time without advance notification and to make changes to the content.**

File: 1.20.91905\_Umbauanleitung\_Selcom\_RCF1\_auf\_TSG\_V1.4\_en.docx  
Printing date: 12/31/2019 10:39:00 AM

---

**Table of contents**

1	Essential information	4
1.1	Value of assembly instructions	4
1.2	Copyright protection	4
1.3	Instructions in the assembly manual	4
1.4	Informal activities performed by the fitter	4
1.5	Requirements for assembly personnel	4
2	Activity performed	5
3	Advantages	5
4	Tools required	5
5	Conversion instructions	6
6	Illustrations	7
7	Contact	11

# **1 Essential information**

## ***1.1 Value of assembly instructions***

The product assembly instructions are provided by the manufacturer or supplier to provide the information required by the customer or fitter to ensure proper, safe and reliable assembly. These brief assembly instructions serve to clarify the basic steps of mechanical assembly. The electrical connection, commissioning and settings of the TSG are explicitly not part of these instructions.

## ***1.2 Copyright protection***

We reserve all rights for this technical documentation. It may not be duplicated, made accessible to third parties or otherwise used in an unauthorized manner without our prior consent. Any changes require our explicit and prior written consent.

## ***1.3 Instructions in the assembly manual***

All instructions in the assembly manual must be followed without exception.

## ***1.4 Informal activities performed by the fitter***

The system fitter is personally responsible for participating in a training course. He or she must inform the manufacturer/supplier without delay of any missing or defective parts in the delivery.

## ***1.5 Requirements for assembly personnel***



Persons responsible for installation and maintenance must be instructed regarding generally applicable safety and labour health requirements. They must be familiar with Langer&Laumann products. Installation tools must be fully functional and measuring instruments must be subject to continuous monitoring.

## 2 Activity performed

Replacement of Fermator door drive with a  **Langer & Laumann Ing. Büro GmbH TSG door drive.**

The purpose of the conversion is to replace the existing Fermator drive with a TSG drive.

## 3 Advantages

- Very economical package.
- Quick and easy replacement with a TSG from  **Langer & Laumann Ing. Büro GmbH .**
- **Just a few** mechanical attachments are required.
- All necessary parts are included with delivery.
- Conversion can be performed **very quickly** and **easily**.
- The electrical wiring can also be performed by **less experienced fitters**.
- **No hand-held** terminal is required for setting parameters. All parameters can easily be adjusted on the device.
- **Measurements can be performed very easily.**
- The conversion kit is available from  **Langer & Laumann Ing. Büro GmbH** as **warehouse inventory**.

## 4 Tools required

Metal drill bits 6, 9, and 11 mm  
Fork wrenches size 8, 10, 13, 17  
Allen wrench set  
Screwdriver  
Side cutter

## 5 Conversion instructions



**NOTE:**

The order of assembly listed here is simply a recommendation. There is no claim of completeness.

1. Removal of the existing drive motor.
2. Assembly of the motor behind the door machine with the "star-shaped" motor adapter plate (see Fig. 7: TSG drive – built-in, view from above / page 9).
3. Refit and tension the toothed belt. (see Fig. 7: TSG drive – built-in, view from above / page 9)
4. For electrical commissioning see the TSG operating instructions.

## 6 Illustrations

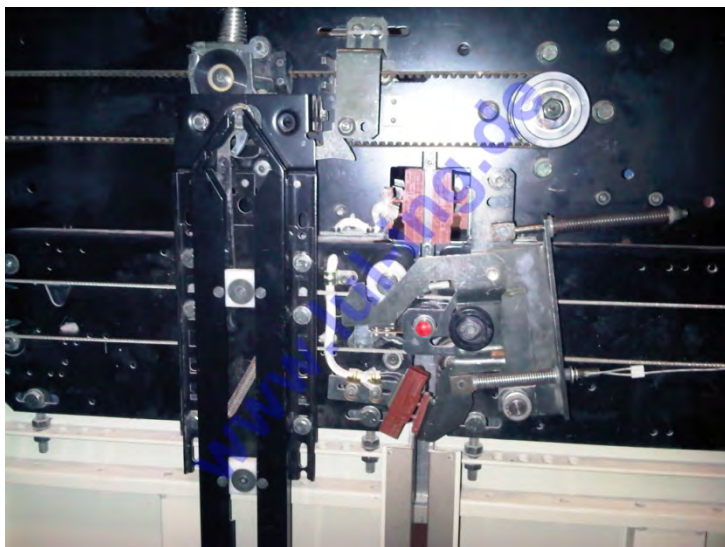

**Fig. 1: Selcom RCF1 door before conversion**



**Fig. 2: TSG drive - assembly 1**



**Fig. 4: TSG drive - assembly 2**

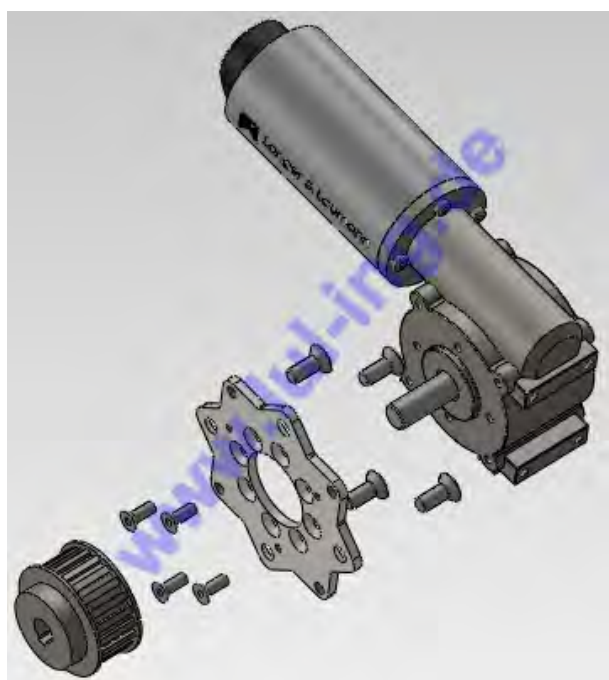
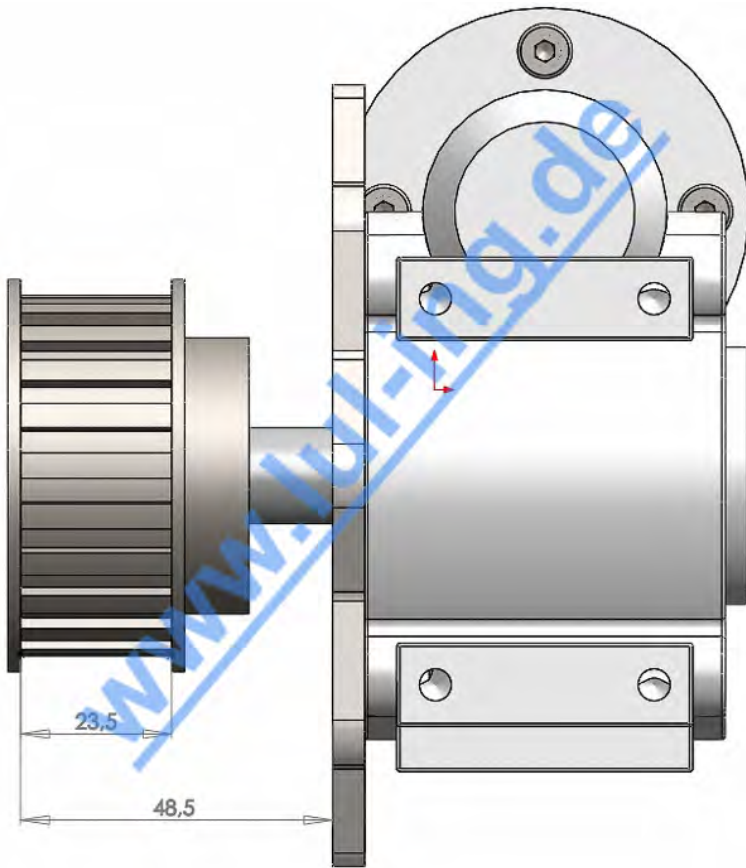

**Fig. 3: TSG drive - exploded view 1**



**Fig. 5: TSG drive - exploded view 2**





**Fig. 6: TSG drive – dimensions cog to gear**



**Fig. 7: TSG drive – built-in, view from above**



**Fig. 8: TSG drive - built-in, view from back**

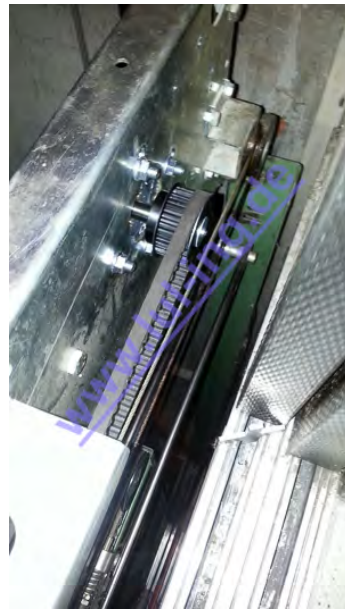

**Fig. 10: TSG built-in - view from the front**



**Fig. 9: TSG drive - built-in, view from back**



**Fig. 11: TSG built-in - view from above**

## 7 Contact

If you have questions or are not certain about something, we can be reached at the following address:

**Langer & Laumann Ing.-Büro GmbH**  
**Wilmsberger Weg 8**  
**48565 Steinfurt**  
**Germany**

Phone: +49 (2552) 92 7 91 0

E-mail: [info@LuL-Ing.de](mailto:info@LuL-Ing.de)

Web: [www.LuL-Ing.de](http://www.LuL-Ing.de)